

the living wall

an ecological sound barrier solution inc.

In Partnership with Mother Nature



416.698.5863

info@thelivingwall.net

www.thelivingwall.net

20 Leslie Street, Suite 121, Toronto, ON M4M 3L4

The Living Wall is a living unit that has enormous environmental benefits including photosynthesis, pollution filtration and soil stabilization.

The Living Wall naturalizes urban and rural environments while providing an ecological privacy structure.

The vegetation used in **The Living Wall** has the ability to root and grow very quickly, therefore providing an almost instant landscape.

All parts of **The Living Wall** are 100% recyclable.

The construction is carefully planned to ensure the controlled growth of roots and shoots. As the vegetation takes root, it matures into an integrated unit that is able to withstand harsh winters and hot summers, while maintaining its aesthetic appeal in all seasons.

The Living Wall uses a willow shrub that is natural to Canada and the United States.

The Living Wall won the 2008 Green Toronto Award for Green Design

The Living Wall is available in two applications:

- PRIVACY/SCREENING FENCING

- NOISE ATTENUATION BARRIER WITH SOIL



PRIVACY/SCREENING FENCING

The Living Wall is based on an old craft using willow to make wicket fences and is patterned on the natural growth of willow.

The Living Wall consists of robust 2 - 3 year old willow of various kinds, joined together with weather resistant laths and posts. This ensures fast and simple erection and controlled growth.

Maintenance consists of an annual trimming of new shoots.

The healthy growing power of willow is the strength of **The Living Wall**.

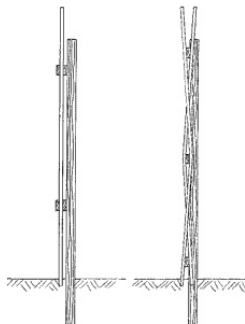

sketch of privacy/screening fence

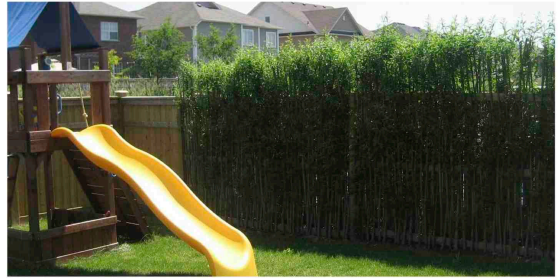

NOISE ATTENUATION BARRIER WITH SOIL

The Living Wall is an ecological sound barrier solution, offering an alternative to standard sound barriers.

The Living Wall integrates ecological principals with engineering practices. Constructed from willow shoots, the wall is enclosed in a biodegradable wooden structure.

The Living Wall compliments the environment as opposed to the intrusive nature of most sound barriers.

The Living Wall naturalizes our urban and rural environments.

Superior sound absorption, the environmental structure, and the financial advantages of **The Living Wall** make it the ideal sound barrier solution when comparing it to other noise walls.

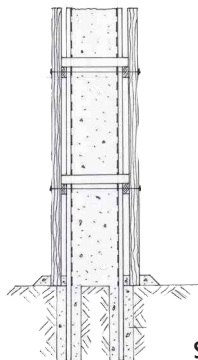

sketch of noise attenuation barrier with soil

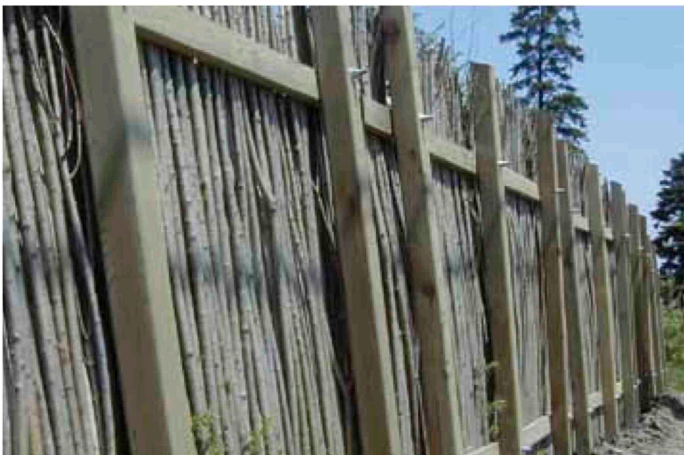

ADVANTAGES AND BENEFITS

Superior sound absorption:

MOE requirements for surface density: 20 kg/m² - 4 lbs/sqft

THE LIVING WALL surface density: 280 kg/m² 60 lbs/sqft

Establishes very quickly

Provides an aesthetically and environmentally pleasing sound barrier

Established the provision of the wind and snow breaks for roadways

Naturally integrates into the environment

Graffiti free

All materials are 100% recyclable

Benefits the ecology by absorbing large quantities of CO₂ which is a major factor in the global green house effect

Aids in storm water run-off

Photosynthesis, pollution filtration and soil stabilization all contribute to a healthy environment

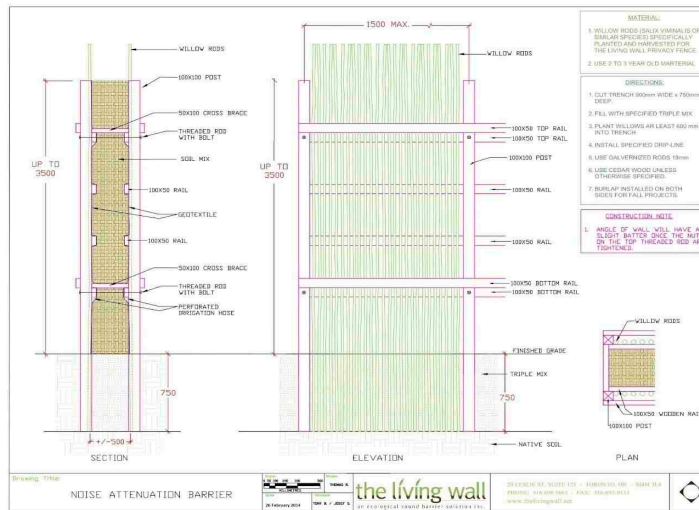
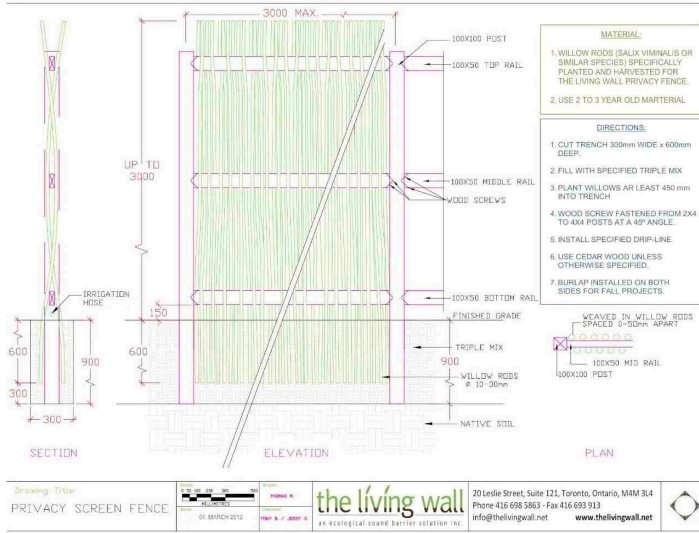

TESTIMONIALS

Solmar Development Corp. purchased the first Noise Barrier Living Wall constructed in Ontario. The Living Wall Noise Barrier was used in one of our subdivisions and we are very happy with the professionalism of the company and the quick and efficient manner of the construction of the Wall. We understand that the residents that purchased the homes that the Living Wall was installed were and are still very happy with this environmentally friendly product that adds in the co2 reduction, beautiful lush green wall, provides the necessary shade and the almost instant landscape growing to a green landscape in just 6 weeks. We would highly recommend for any use screening or for noise attenuation and will definitely be considering the Living Wall for Solmar's many upcoming communities which are centered on the model of sustainable living.

Maurizio Rogato Vice President of Land Development Solmar Development Corp.

The apartment building we constructed was right by an expressway so it required a sound attenuation barrier. We were extremely pleased to discover The Living Wall. Besides having noise abatement properties it is also aesthetically appealing. Given that the willow plantings went up right next to a recreation area used by the tenants, it provided a more attractive alternative to common concrete barriers. We were also impressed with the professionalism of The Living Wall staff and that the willow hedge needs very little maintenance.

Mark Thompson, former Chair of Trellis Housing Initiatives

I absolutely love The Living Wall screen fence that I had installed in my backyard. The Living Wall screen fence provides my backyard with privacy and a sense of tranquility because of its unique design. Sitting in my backyard in the middle of the city I feel surrounded by nature. The Living Wall screen fence eliminates that boxed in feeling that most pressure treated wood fenced backyards provide and replaces it with a lush, green, serene backyard. The screen fence has also been a great investment because it requires minimal care in terms of watering or trimming, while it matures and sprouts quickly.

Karen Diamond -Home owner

The Goldman Group retained the services of The Living Wall Inc. to install a 400 metre long Noise Attenuation Wall at 350 Danforth Road in Toronto, buffering their subdivision from the TTC bus depot. This Noise Attention Wall is the longest such wall that has been installed in North America. The Living Wall Inc. were extremely service oriented and reacted promptly to any client requests on the project. The product was installed in a timely manner and the willows lining the Noise Attenuation Wall matured quickly into a lush green fence. It has been 2 years since The Living Wall Noise Attenuation fence was installed and the product continues to be a lush, green barrier shielding the subdivision from the noisy bus depot. The Goldman Group has continued to receive very positive feedback from the homeowners, and numerous other groups for this "Green" application.

Jeremy Alter, Director of Construction for The Goldman Group

In Partnership with Mother Nature



416.698.5863
info@thelivingwall.net
www.thelivingwall.net
20 Leslie Street, Suite 121, Toronto, ON M4M 3L4